

25 August 2022

The Owner/Resident

Kia ora Neighbour

An update on our plans for 341 Bucklands Beach Road and 122 Gills Road, Bucklands Beach

We wrote to you in March 2022 to advise that Kāinga Ora is intending to redevelop its land at 341 Bucklands Beach Road and 122 Gills Road, Bucklands Beach. We are now writing to advise that Auckland Council has granted resource consent for the development.

Our intention is to better utilise land currently occupied by a small number of old houses on large sections. We will do this by building a greater variety of new, warm, healthy homes, designed to complement the local environment and meet the needs of today's tenants.

The redevelopment at this location will see 2 old homes replaced with 6 warm, dry, modern homes. These will be made up of:

- 1x 3+1 Bedroom Accessible Stand Alone House
- 2x 3 Bedroom Duplex
- 3x 2 Bedroom Terraces

A site plan and landscape plan are enclosed. We will be in touch with construction details once confirmed with our build partner.

For more information on the Auckland Housing Programme, please visit our website at:
[Public housing developments :: Kāinga Ora – Homes and Communities \(kaingaora.govt.nz\)](http://Public housing developments :: Kāinga Ora – Homes and Communities (kaingaora.govt.nz))

If you have any questions or concerns about any of the Kāinga Ora sites, please get in touch via email or contact phone below and ask to speak to a Stakeholder Relationship Manager in the Central East Auckland Team.

Hei konā mai

Community Engagement and Partnerships

Central East Auckland

Tāmaki Makaurau / Te Tai Tokerau

Email: centraleastakl.region@kaingaora.govt.nz

Freephone : 0800 801 601

Site Plan

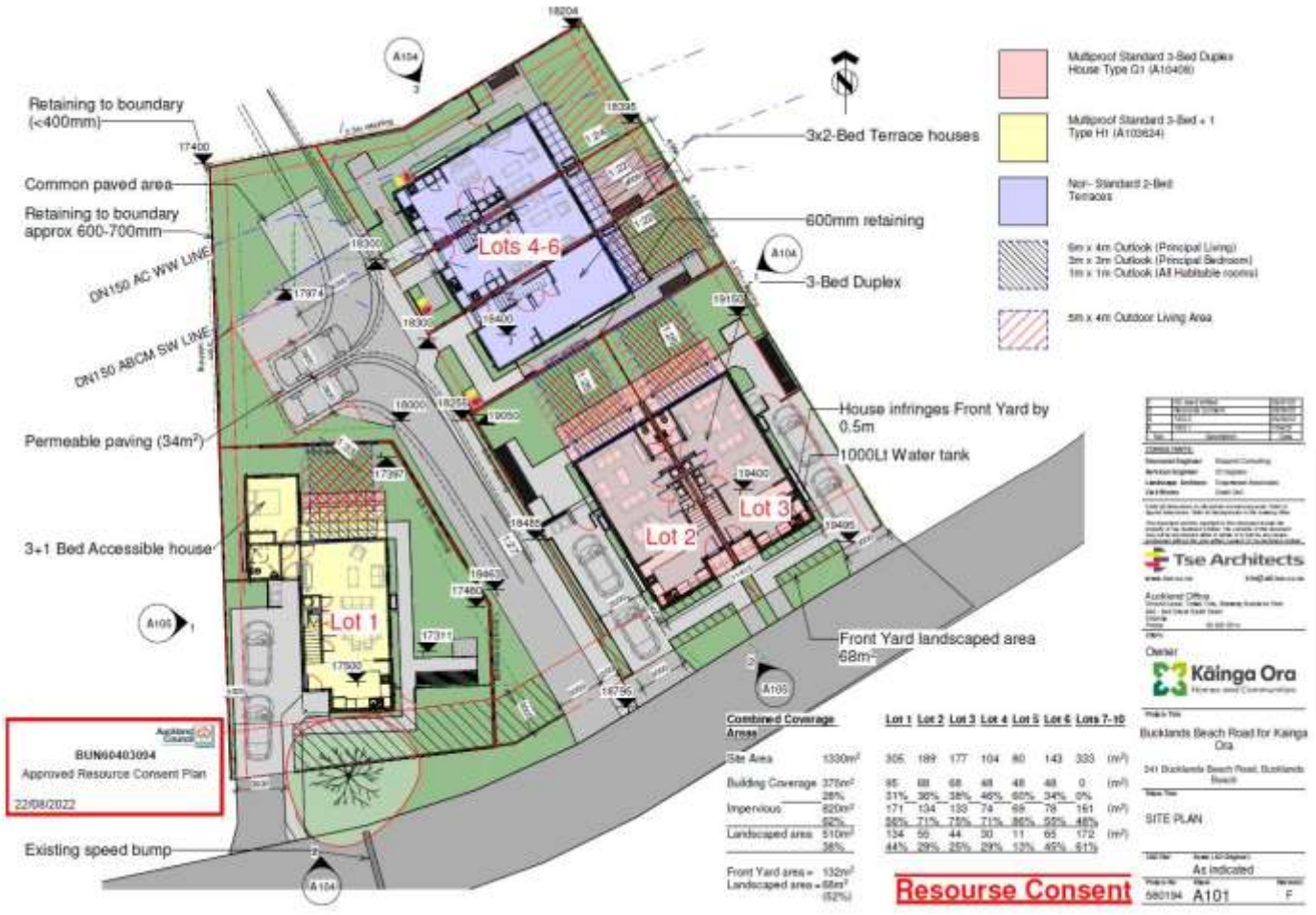

BUN66403094
Approved Resource Consent Plan
22/08/2022

Tse Architects
Auckland Office
241 Bucklands Beach Road, Bucklands Beach
021 623 6236
www.tse.co.nz

Kāinga Ora
Homes and Communities

241 Bucklands Beach Road, Bucklands Beach

SITE PLAN

Scale: As Indicated
Date: 5/8/19
No: 580194
A101
F

Landscape Plan

Bucklands Beach 341 Rd and CB1 Rd 122, Bucklands Beach (RC Package)
CONCEPT DESIGN
SOFTSCAPE STRATEGY

SCALE: 1:2000A3
0 2.5 5 10m

- Key**
- SOFTSCAPE**
- Lawn
- Planting Mixes**
- Mix 1 | Mass Amenity Planting | See Species List
 - Mix 2 | Narrow / Skala Mix Planting | See Species List
 - Mix 3 | JGAL Amenity Planting | See Species List
 - Climber | See Species List
- Trees***
- Specimen Trees**
 - V.ki | Post
 - A.ze | Tidal
 - C.ki | Karaka
 - H.pn | Houtuhe
 - K.co | Coastal Kōwhiri
 - Smaller Trees + Large Shrubs**
 - F.co | Rauhi Kari
 - F.cy | Cyril Watson
 - H.ki | Pratanika
 - H.wi | Weeping Weiphi
 - S.sh | Stephens Dragon Golf
 - Fruit trees**
 - C.ki | Mandarin Kiwano
 - F.wi | Feijoa
 - C.co | Macleod's satsuma
 - C.ji | Japanese (Lemon Tree)
 - C.oe | Orange 'Best Sweetest'
- *See species list for further information
- Existing Tree**

BUN60403994
Approved Resource Consent Plan
22/08/2022

