

21 December 2021

Dear Neighbour,

### **An update on 16 Nash Road, Mt Roskill**

We wrote to you in July 2021 to advise that Kāinga Ora (formerly Housing New Zealand) is intending to redevelop its land at 16 Nash Road, Mt Roskill. We are now writing to advise that Auckland Council has granted resource consent for this development.

Our intention is to better utilise these sections by building a greater variety of new, warm, healthy homes, designed to complement the local environment and meet the needs of today's tenants.

The redevelopment at this location will see one old home replaced with three warm, dry, modern homes. These will be made up of:

- 2 x two-bedroom homes on a two-storey duplex
- 1 x three-bedroom two storey home

A site plan and landscape plan are enclosed. We will be in touch with construction details once confirmed with our build partner.

For more information on the Auckland Housing Programme, please visit our website at <https://kaingaora.govt.nz/developments-and-programmes/what-were-building/public-housing-developments/>

If you have any questions or concerns about any of the Kāinga Ora sites, please get in touch via email or contact phone below and ask to speak to Mayur or a Stakeholder Relationship Manager in the Central East Auckland Team.

Naku noa

**Community Engagement and Partnerships Team**  
Central East Auckland

Freephone: 0800 801 601  
Email: [centraleastakl.region@kaingaora.govt.nz](mailto:centraleastakl.region@kaingaora.govt.nz)

Figure 1: 16 Nash Road, Landscape Plan

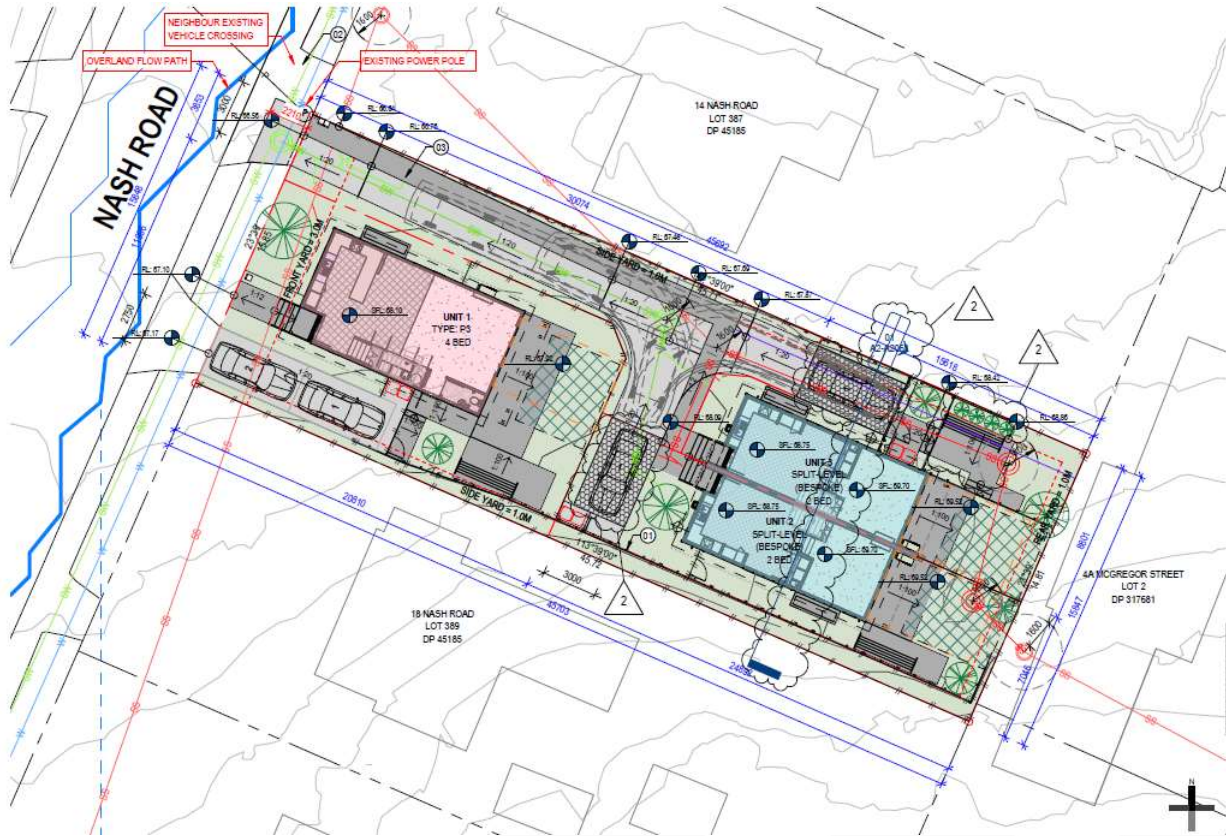

Figure 2: 16 Nash Road, Site Plan

