

16 June 2022

The Owner/ Resident

Kia ora Sir/Madam

### **An update on our plans for 6 – 10 Kettle Street, Pt Chevalier**

We wrote to you in March 2022 to advise that Kāinga Ora is intending to redevelop its land at 6 – 10 Kettle Street, Pt Chevalier. We are now writing to advise that Auckland Council has granted resource consent for the development.

Our intention is to better utilise land currently occupied by a small number of old houses on large sections. We will do this by building a greater variety of new, warm, healthy homes, designed to complement the local environment and meet the needs of today's tenants.

The redevelopment at this location will see 4 old homes replaced with 9 warm, dry, modern homes. These will be made up of:

- 2 x two bedroom properties
- 6 x three bedroom properties
- 1 x 3+1 bed bedroom properties

A site plan and landscape plan are enclosed.

Work will start in late August / early September starting with site clearance and the removal of the old, existing houses.

### **Safety first**

The first step in this process will be to check if there is any asbestos in the home and if so we will safely remove this. Like many other homes of the era (and other types of building built pre mid-1980s), these properties may have some low risk asbestos that needs to be removed before demolition can begin. Independent tests have confirmed there is no risk to surrounding areas or neighbours from this.

Kāinga Ora has contracted an accredited asbestos-removal company to do this work. They will operate in accordance with the Health and Safety at Work (Asbestos) Regulations 2016 to ensure the safe and efficient removal, transportation and disposal of the material containing asbestos.

### How long will the work take?

The removal of the asbestos and associated work will take approximately four to six weeks. Demolition of the existing property will follow shortly after followed by construction of the new homes late this year or early in the New Year. We will provide more information in relation to construction in the new few weeks.

For more information on the Auckland Housing Programme, please visit our website at [Small to medium-scale developments: Kāinga Ora – Homes and Communities \(kaingaora.govt.nz\)](http://www.kaingaora.govt.nz)

If you have any questions or concerns about any of the Kāinga Ora sites, please get in touch via email or contact phone below and ask to speak to a Stakeholder Relationship Manager in the Central East Auckland Team.

Hei konā mai

### Community Engagement and Partnerships

Central East Auckland

Email: [centraleastakl.region@kaingaora.govt.nz](mailto:centraleastakl.region@kaingaora.govt.nz)

Tāmaki Makaurau / Te Tai Tokerau

Freephone : 0800 801 601

Kettle Street site plan

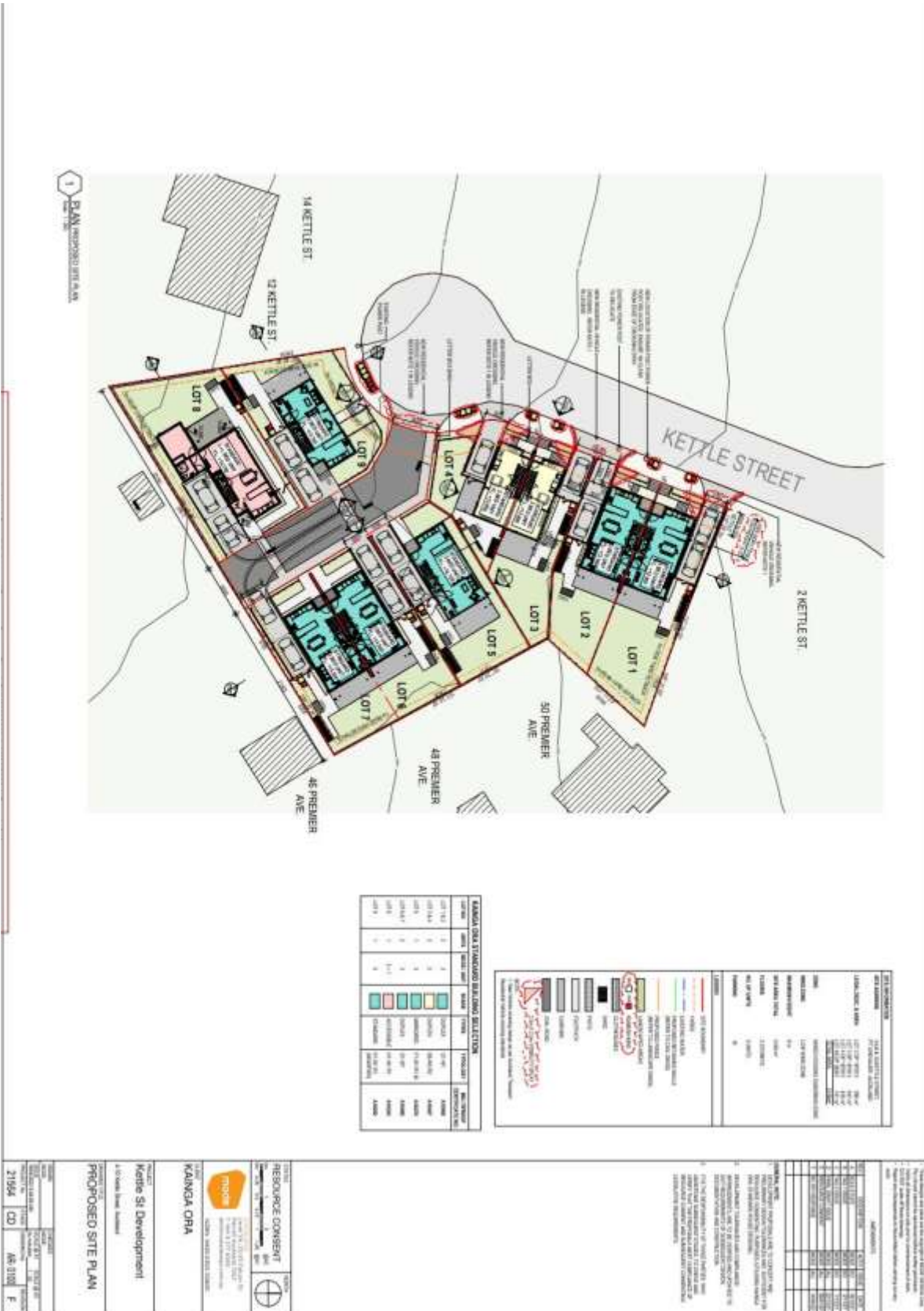

Kettle Street landscape plan

